

Customer Number: _____ Customer Name: _____

Township: **Harrison(S)**

S½ NE¼ S13-T34N-R8E

Bond Info: **Bond Amount(25% of bid)\$** _____

Choose method by which performance bond will be posted or secured.

Please check (✓) one: Cash or Check Irrevocable Letter of Credit

Approximate cutting area: **18 acres**

Product Species	Estimated Unit Volume	Minimum Bid Per Unit	Estimated Value	Bid Per Unit	Total
20-TA Aspen Pulp	Tons	70.00	7.70	539.00	_____
20-TMX Mixed Hardwood Pulp	Tons	370.00	7.00	2,590.00	_____
20-TBA Basswood Pulp	Tons	15.00	1.40	21.00	_____
20-TF Fir Pulp	Tons	110.00	3.50	385.00	_____
10-MX Mixed Hardwood Sawlogs	MBF	11.00	105.00	1,155.00	_____
10-BA Basswood Sawlogs	MBF	2.00	91.00	182.00	_____
Total estimated value of accepted bid			4,872.00		_____
Bidder's Signature _____				Date _____	Total Bid

CONTRACT AVAILABLE FOR INSPECTION

- 1) Clearcut area: cut all living trees greater than 1 inch in diameter except for yellow birch, oak, butternut, spruce, tamarack, pine, cedar, cherry, hemlock, apple, and hawthorn. Do not cut non-merchantable trees in low wet areas and drainages. Pockets of non-merchantable fir that will not impede aspen regeneration may be left uncut with prior approval from the Lincoln County Forestry Department. Snags and dead trees are only to be cut if leaving them standing presents a safety hazard to the harvesting operation. Snags and dead trees cut for safety reasons must be left in the harvest area and may not be utilized.
- 2) All logging damage/debris must be corrected/removed from trails, woods roads, and grass openings daily and prior to sale closure. Slash will be left where it falls unless the contractor wishes to use it to prevent ruts, soil compaction and erosion during logging operations.
- 3) Any roadwork will require prior approval from the Lincoln County Forestry Department and must follow BMP guidelines. Contractor is responsible for installing broad based dips, water bars and/or using other soil stabilizing techniques where appropriate.
- 4) Ingress and egress to this sale is the responsibility of the contractor.
- 5) Permission must be granted by the Forestry Department to use the snowmobile trail from December 1 to March 31. Ample snow cover must be maintained to allow safe snowmobile operation.
- 6) This sale is limited to short wood skidding only.
- 7) Special care must be taken to limit damage to advanced regeneration/Special care must be taken to limit damage to saplings. All spring poles (saplings tipped over from harvesting operations) will be cut at the base.
- 8) Mixed hardwood pulp weight estimate is approximately: 8% white birch. Mixed hardwood sawlog volume estimate is approximately: 86% red maple & 12% hard maple.

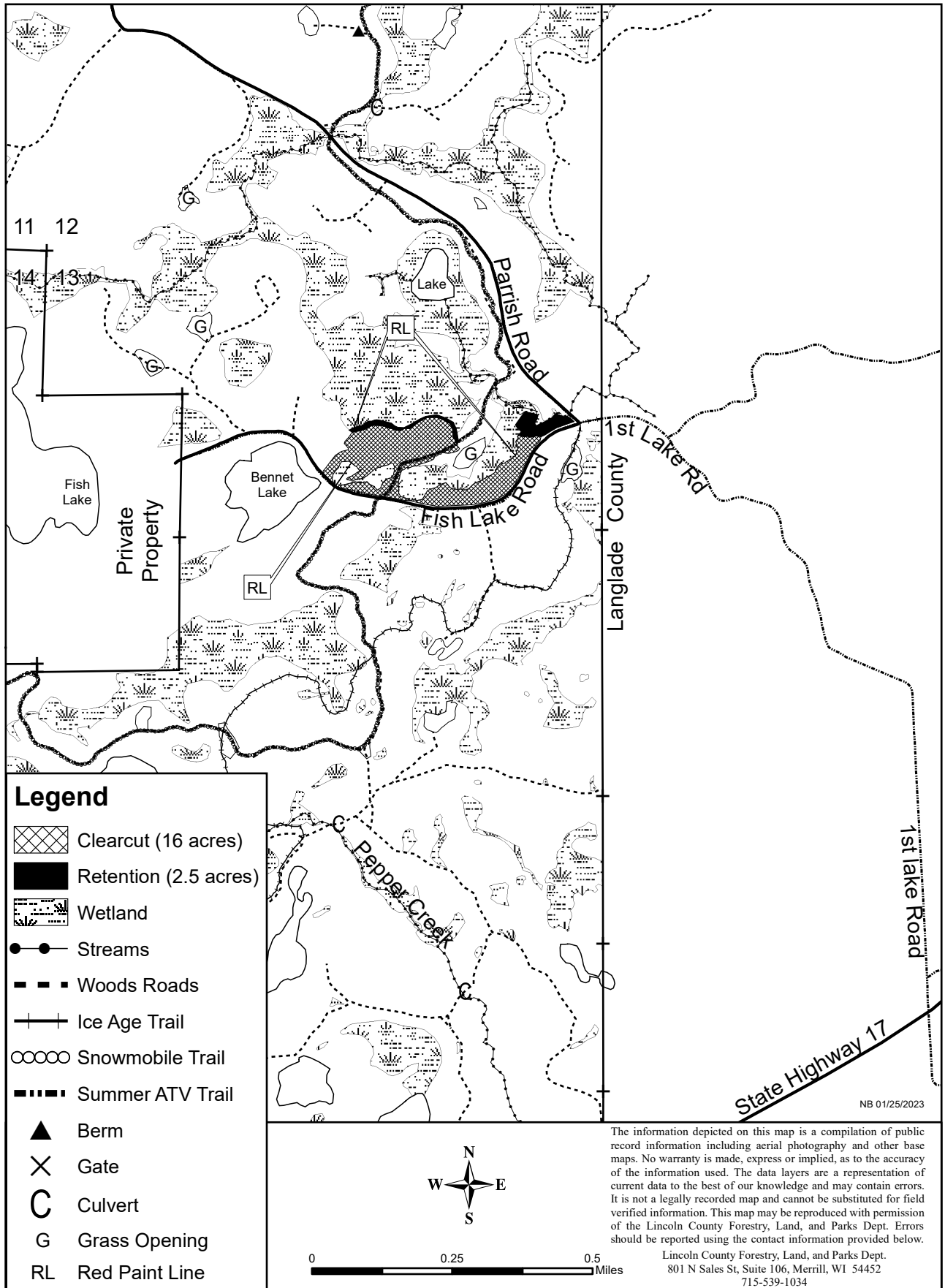

T014-24