

ExpressVote Universal Voting System

Ballot Marking Configuration

Poll Worker Quick Start Guide



ExpressVote Components

- | | |
|-----------------------------|---------------------------------|
| 1 Access compartment | 5 Headphone jack |
| 2 Power source indicator | 6 Paper ballot feed |
| 3 Battery status indicator | 7 Touch screen |
| 4 Accessibility device port | 8 Paper path access compartment |

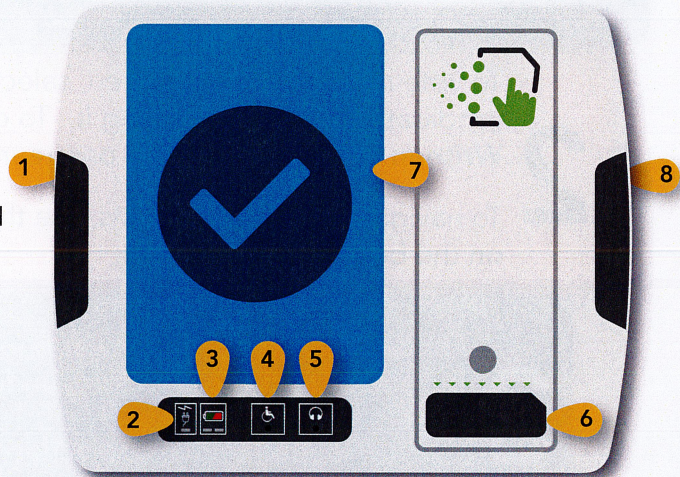

Preparing the ExpressVote for Voting

- 1 Unlock and open the Access Compartment door.
Turn the power switch to the **ON** position. Allow the ExpressVote to complete its power-up process.

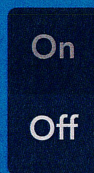

- 2 Ensure the mode switch is set to **Voter** to prepare the machine for voting.
Close and lock the Access Compartment. Follow your jurisdiction's requirements for securing the Access Compartment with seals.

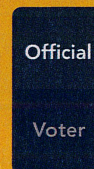

Voting on the ExpressVote

- 1 Initiate the voting session by inserting an unmarked voter activation card into the paper ballot feed.
If needed, select the appropriate precinct, ballot, and language.



- 2 To vote using the touch screen, select the contest or other candidate choice by touching it. To cast a write-in vote, touch the **Write-in** option and use the onscreen keyboard to enter the name.
To navigate between contests, use the **Next** or **Previous** buttons on the bottom of the screen.



- 3 For assistive voting, plug headphones into the jack and detach the audio-tactile keypad from under the Access Compartment.
Use the keypad to make selections, following the audio instructions on the headphones.

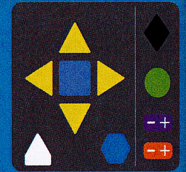

- 4 At the end of voting, verify your selections. Touch **Print Card** to print your completed card.
Remove your ballot from the paper ballot feed. Place your ballot card into your jurisdiction's tabulation device.

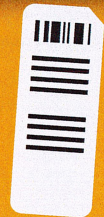

Shutting Down & Storing the ExpressVote

- 1 At the end of voting, unlock and open the Access Compartment.
Turn the power switch to the **Off** position. Close and lock the Access Compartment.

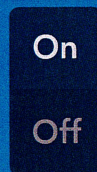

- 2 Allow the ExpressVote to completely power down. Remove the headphones and unplug the terminal from AC power.
Store the ExpressVote according to your jurisdictional instructions.

